

NOTES

1. Contractors must check all dimensions on site. Only figured dimensions are to be worked from. Discrepancies must be reported to the Architect or Engineer before proceeding. © This drawing is copyright.
2. Direct scaling off the drawing is permissible for planning purposes only.

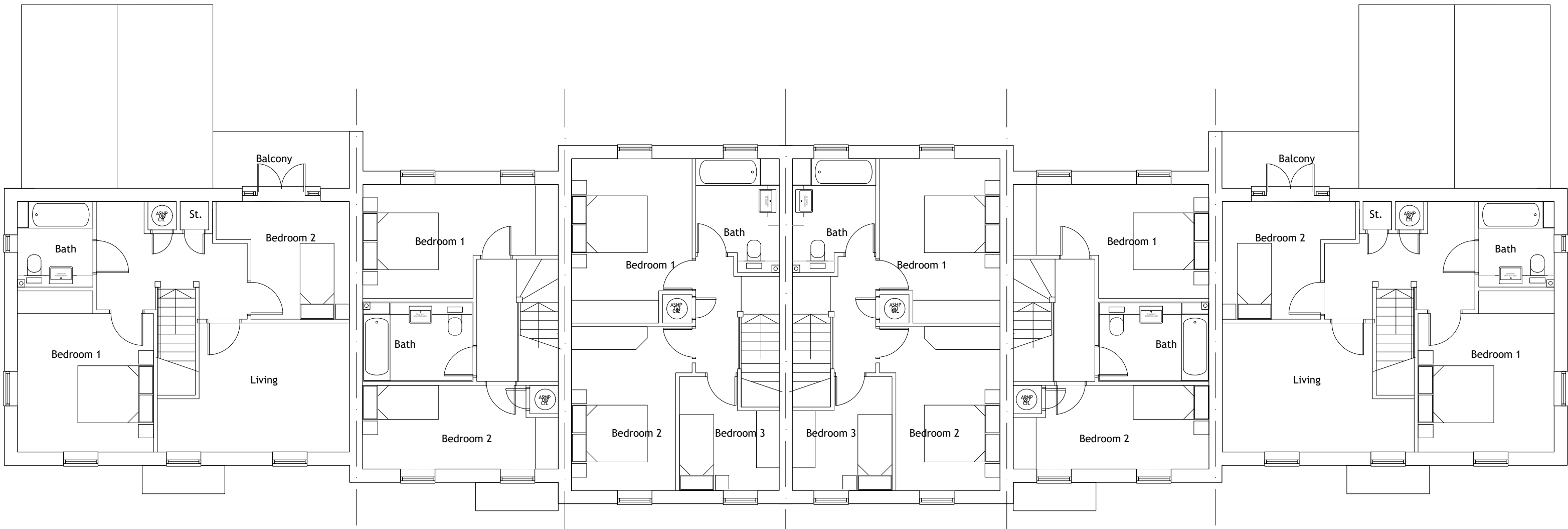

Type M1.1  
First Floor Plan.

Type M2  
First Floor Plan.

Type M3  
First Floor Plan.

Type M3  
First Floor Plan.

Type M2  
First Floor Plan.

Type M1.1  
First Floor Plan.

A	Floor plans changed to show the handed dwellings, as shown on the elevations. Title of PDF and title block amended.			AKS	AT	08.05.2025
REV	DESCRIPTION			DRN	CHD	DATE
<input type="checkbox"/>	PRELIMINARY		<input type="checkbox"/> INFORMATION	<input type="checkbox"/> TENDER		
<input type="checkbox"/>	CONSTRUCTION		<input type="checkbox"/> AS BUILT			
SCALE	1:100 @ A2		DATE	Oct. 2024		
DRAWN	AKS		CHK	AT		
DRAWING NO.	19400/167		REV	A		
TITLE	Redevelopment of Former Animal Testing Research Facility, Kentford.					
DETAILS	House Type M1- r, M1.1- r, M2- r & M3- f First Floor Plans Plots 206-213					

Woods Hardwick

Architecture | Engineering | Planning | Surveying

BEDFORD : HEAD OFFICE  
15-17 Goldington Road  
Bedford MK40 3NH  
T: +44 (0) 1234 268862

BIRMINGHAM  
Fort Dunlop, Fort Parkway  
Birmingham B24 9FE  
T: +44 (0) 121 6297784

ONLINE: mail@woodshardwick.com | woodshardwick.com

