

First Floor Plan.

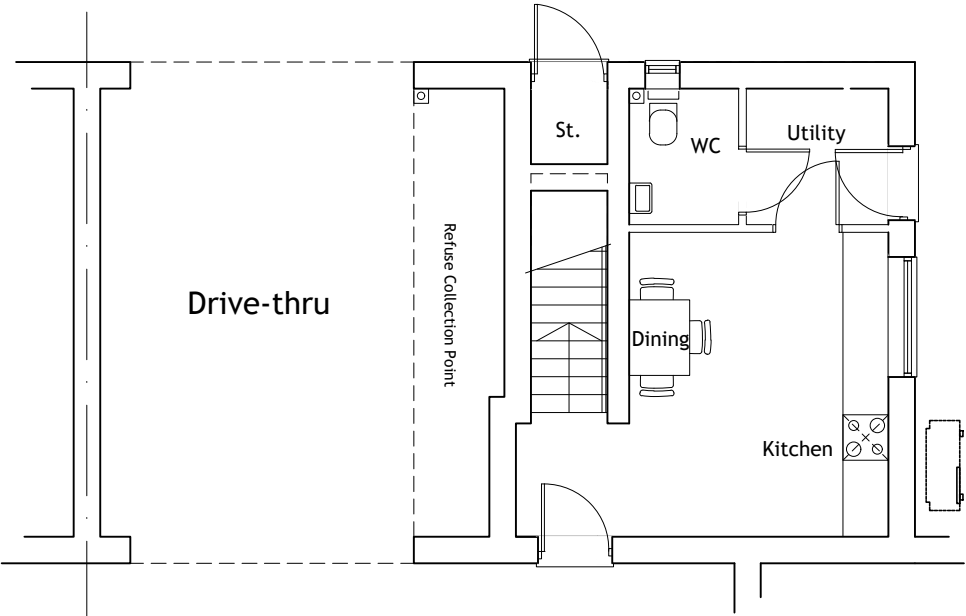

Ground Floor Plan.
87.3sq.m / 939.6sq.ft.
2 Bed 3 Person.

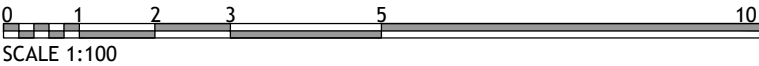

NOTES

- Contractors must check all dimensions on site. Only figured dimensions are to be worked from. Discrepancies must be reported to the Architect or Engineer before proceeding.
© This drawing is copyright.
- Direct scaling off the drawing is permissible for planning purposes only.

LOCHAILORT

REV	DESCRIPTION		DRN	CHD	DATE
<input checked="" type="checkbox"/>	PRELIMINARY	<input type="checkbox"/>	INFORMATION	<input type="checkbox"/>	TENDER
<input type="checkbox"/>	CONSTRUCTION	<input type="checkbox"/>	AS BUILT		
SCALE	1:100 @ A3	DATE	Oct. 2024		
DRAWN	AS	CHK	JL		
DRAWING NO.	19400/178	REV	-		
TITLE	Redevelopment of Former Animal Testing Research Facility, Kentford.				
DETAILS	House Type CH2.1-tb Floor Plans				

 **Woods Hardwick**
Architecture | Engineering | Planning | Surveying

BEDFORD : HEAD OFFICE
15-17 Goldington Road
Bedford MK40 3NH
T: +44 (0) 1234 268862

BIRMINGHAM
Fort Dunlop, Fort Parkway
Birmingham B24 9FE
T: +44 (0) 121 6297784

ONLINE: mail@woodshardwick.com | woodshardwick.com