

- NOTES
1.

Contractors must check all dimensions on site. Only figured dimensions are to be worked from. Discrepancies must be reported to the Architect or Engineer before proceeding.  
© This drawing is copyright.
2.

Direct scaling off the drawing is permissible for planning purposes only.

LOCHAILORT

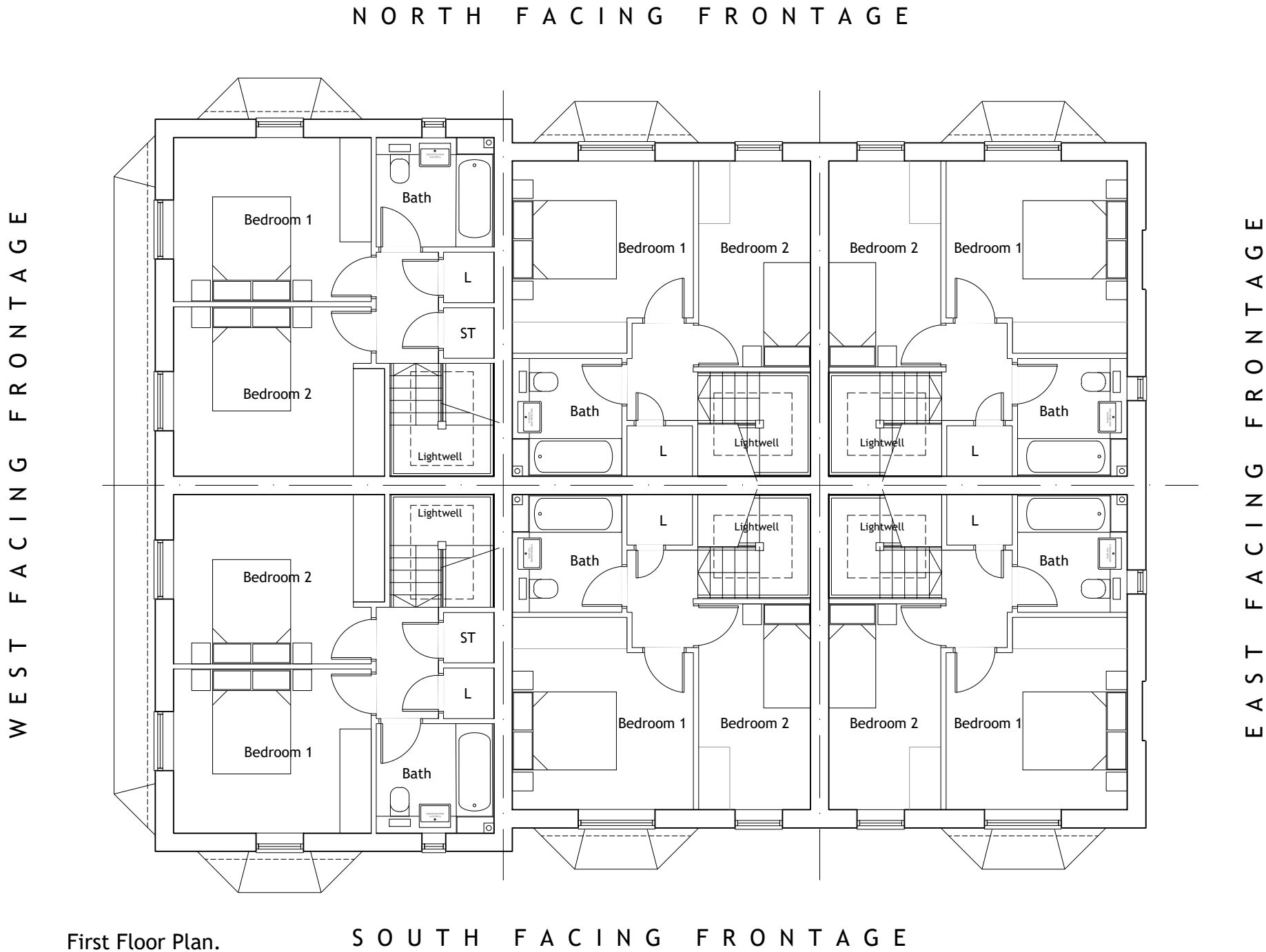

REV	DESCRIPTION	DRN	CHD	DATE
<input checked="" type="checkbox"/> PRELIMINARY	<input type="checkbox"/> INFORMATION	<input type="checkbox"/> TENDER		
<input type="checkbox"/> CONSTRUCTION	<input type="checkbox"/> AS BUILT			
SCALE	1:100 @ A3	DATE	Oct. 2024	
DRAWN	AS	CHK	JL	
DRAWING NO.	19400/196	REV	-	
TITLE	Redevelopment of Former Animal Testing Research Facility, Kentford.			
DETAILS	Maisonette Complex 3 First Floor Plans			

Woods Hardwick

Architecture | Engineering | Planning | Surveying

BEDFORD : HEAD OFFICE

15-17 Goldington Road

Bedford MK40 3NH

T: +44 (0) 1234 268862

BIRMINGHAM

Fort Dunlop, Fort Parkway

Birmingham B24 9FE

T: +44 (0) 121 6297784

ONLINE: mail@woodshardwick.com | woodshardwick.com

PLEASE CONSIDER THE ENVIRONMENT BEFORE PRINTING THIS DRAWING

