

NOTES

1. Contractors must check all dimensions on site. Only figured dimensions are to be worked from. Discrepancies must be reported to the Architect or Engineer before proceeding.  
© This drawing is copyright.
2. Direct scaling off the drawing is permissible for planning purposes only.

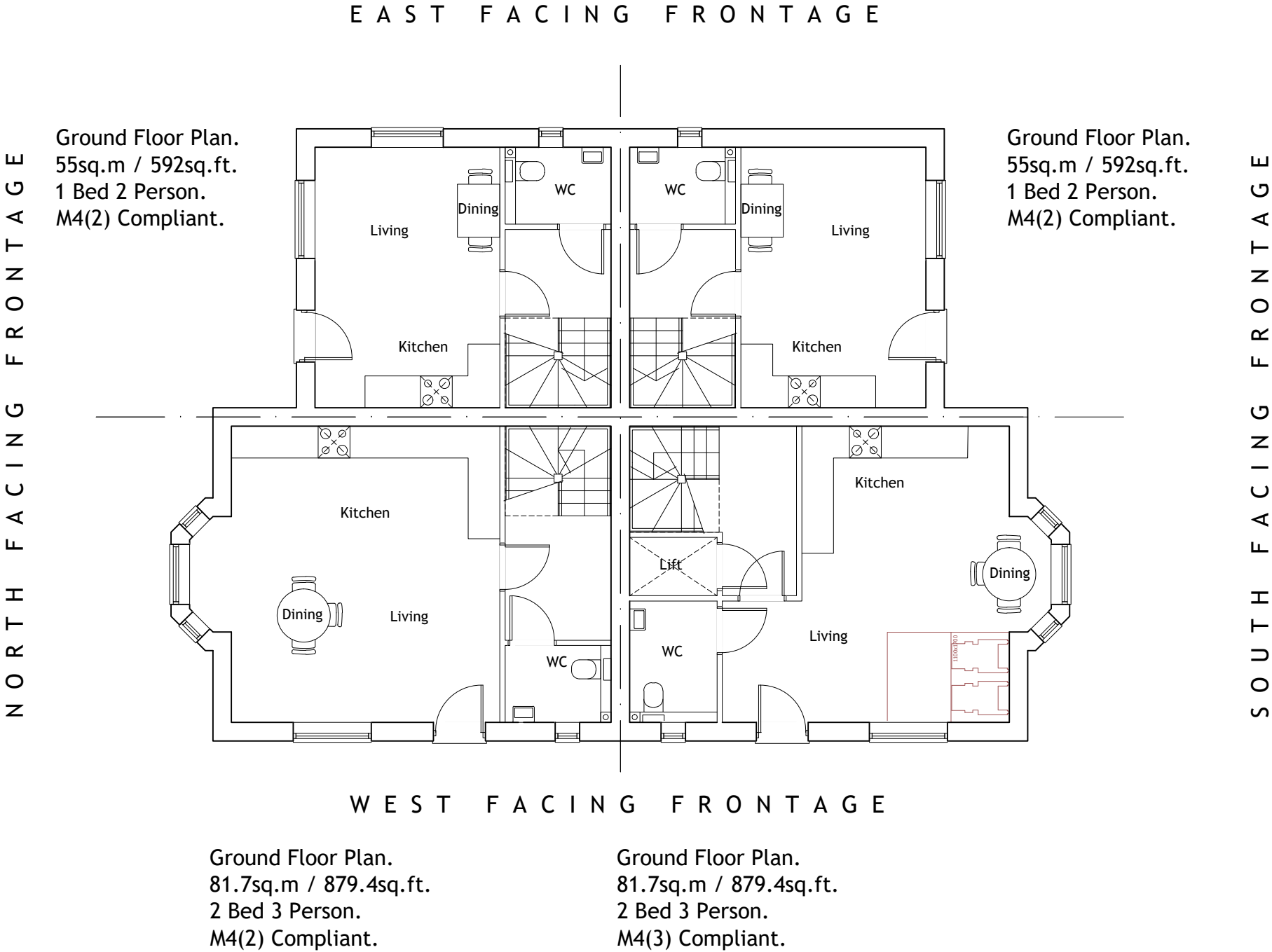

REV	DESCRIPTION	DRN	CHD	DATE	
<input checked="" type="checkbox"/>	PRELIMINARY	<input type="checkbox"/>	INFORMATION	<input type="checkbox"/>	TENDER
<input type="checkbox"/>	CONSTRUCTION	<input type="checkbox"/>	AS BUILT		
SCALE	1:100 @ A3	DATE	Oct. 2024		
DRAWN	AS	CHK	JL		
DRAWING NO.	19400/199	REV	-		
TITLE	Redevelopment of Former Animal Testing Research Facility, Kentford.				
DETAILS	Maisonette Complex 4 Ground Floor Plans				

Woods Hardwick

Architecture | Engineering | Planning | Surveying

**BEDFORD : HEAD OFFICE**  
15-17 Goldington Road  
Bedford MK40 3NH  
T: +44 (0) 1234 268862

**BIRMINGHAM**  
Fort Dunlop, Fort Parkway  
Birmingham B24 9FE  
T: +44 (0) 121 6297784

ONLINE: [mail@woodshardwick.com](mailto:mail@woodshardwick.com) | [woodshardwick.com](http://woodshardwick.com)

PLEASE CONSIDER THE ENVIRONMENT BEFORE PRINTING THIS DRAWING

