

NOTES

1. Contractors must check all dimensions on site. Only figured dimensions are to be worked from. Discrepancies must be reported to the Architect or Engineer before proceeding. © This drawing is copyright.
2. Direct scaling off the drawing is permissible for planning purposes only.

LOCHAILORT

Type M1  
Ground Floor Plan.  
58.1sq.m / 625sq.ft.  
1 Bed 2 Person.

Type M1  
Ground Floor Plan.  
58.1sq.m / 625sq.ft.  
1 Bed 2 Person.

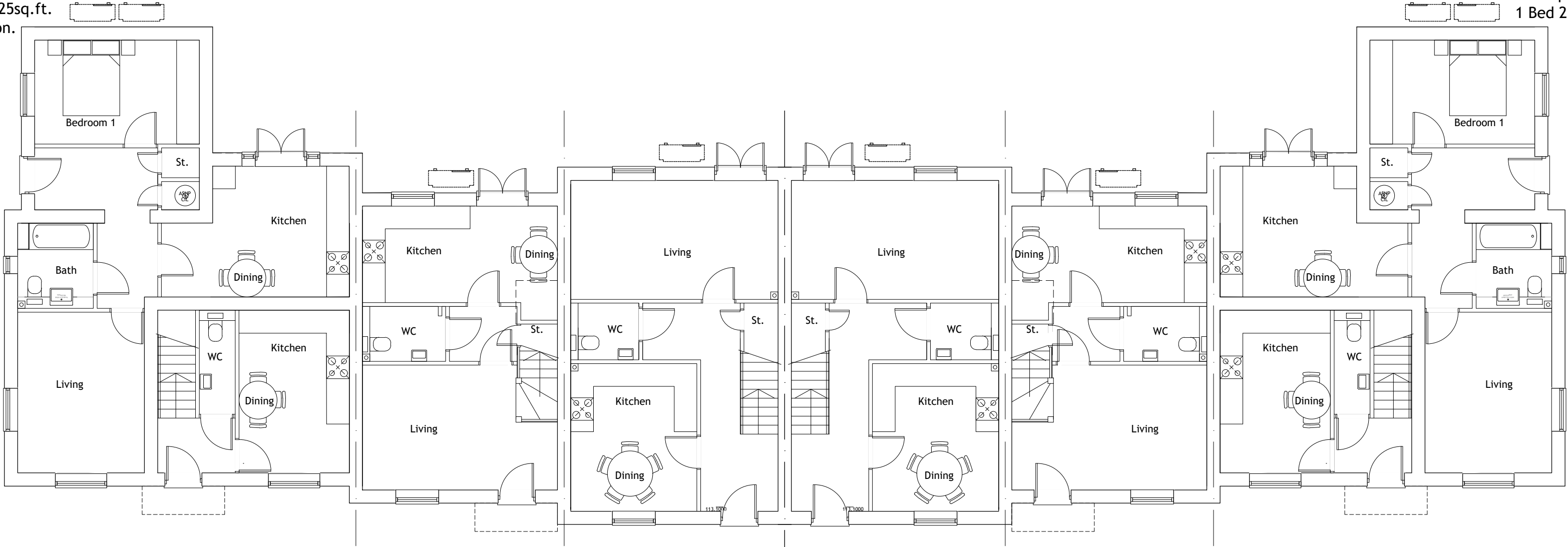

Type M1.1  
Ground Floor Plan.  
57.9sq.m / 836.3sq.ft.  
2 Bed 4 Person.

Type M2  
Ground Floor Plan.  
77.4sq.m / 833sq.ft.  
2 Bed 3 Person.

Type M3  
Ground Floor Plan.  
92sq.m / 990sq.ft.  
3 Bed 5 Person.

Type M3  
Ground Floor Plan.  
92sq.m / 990sq.ft.  
3 Bed 5 Person.

Type M2  
Ground Floor Plan.  
77.4sq.m / 833sq.ft.  
2 Bed 3 Person.

Type M1.1  
Ground Floor Plan.  
57.9sq.m / 836.3sq.ft.  
2 Bed 4 Person.

Floor plans changed to show the handed dwellings, as shown on the elevations. Title of PDF and title block amended.

REV	DESCRIPTION	DRN	CHD	DATE
	<input type="checkbox"/> PRELIMINARY	<input type="checkbox"/> INFORMATION	<input type="checkbox"/> TENDER	
	<input type="checkbox"/> CONSTRUCTION	<input type="checkbox"/> AS BUILT		

SCALE	1:100 @ A2	DATE	Mar. 2025
-------	------------	------	-----------

DRAWN	AKS	CHK	AT
-------	-----	-----	----

DRAWING NO.	19400/252	REV	A
-------------	-----------	-----	---

TITLE	Redevelopment of Former Animal Testing Research Facility, Kentford.
-------	---

DETAILS	House Type M1- r, M1.1- r, M2- r & M3- f Ground Floor Plans Plots 220-227
---------	--

Woods Hardwick

Architecture | Engineering | Planning | Surveying

BEDFORD : HEAD OFFICE

15-17 Goldington Road

Bedford MK40 3NH

T: +44 (0) 1234 268862

BIRMINGHAM

Fort Dunlop, Fort Parkway

Birmingham B24 9FE

T: +44 (0) 121 6297784

ONLINE: mail@woodshardwick.com | woodshardwick.com

