

NOTES

1. Contractors must check all dimensions on site. Only figured dimensions are to be worked from. Discrepancies must be reported to the Architect or Engineer before proceeding.  
© This drawing is copyright.
2. Direct scaling off the drawing is permissible for planning purposes only.

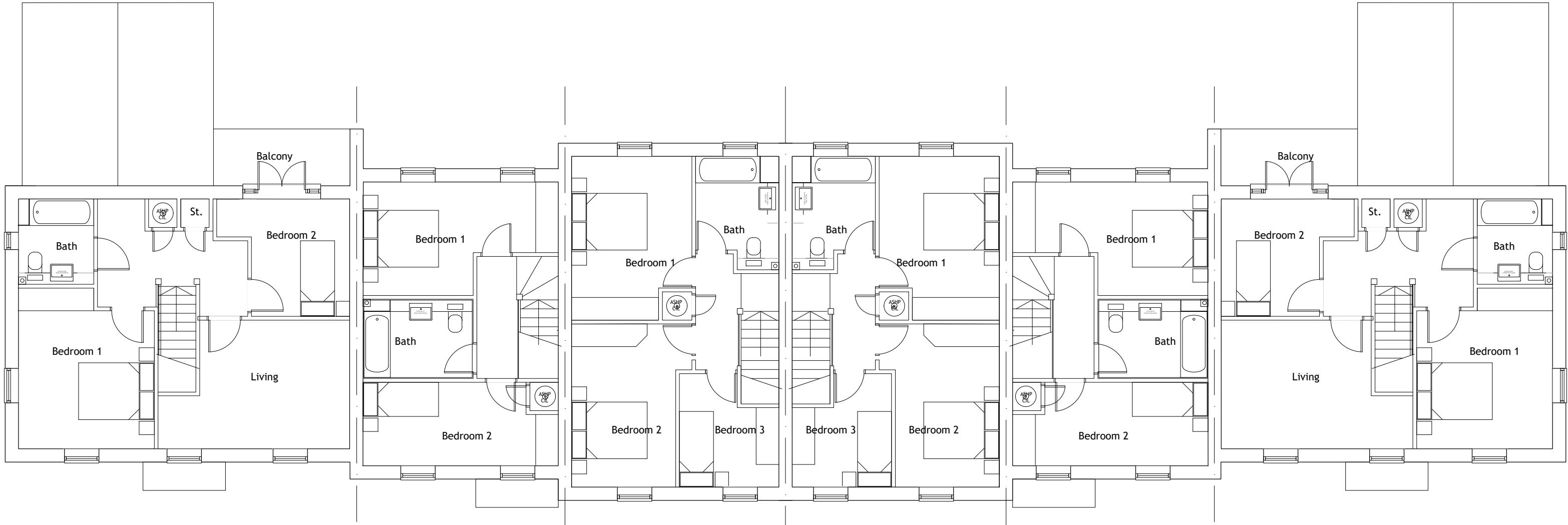

Type M1.1  
First Floor Plan.

Type M2  
First Floor Plan.

Type M3  
First Floor Plan.

Type M3  
First Floor Plan.

Type M2  
First Floor Plan.

Type M1.1  
First Floor Plan.

A	Floor plans changed to show the handed dwellings, as shown on the elevations. Title of PDF and title block amended.			AKS	AT	08.05.2025
REV	DESCRIPTION			DRN	CHD	DATE
<input type="checkbox"/>	PRELIMINARY		<input type="checkbox"/> INFORMATION	<input type="checkbox"/> TENDER		
<input type="checkbox"/>	CONSTRUCTION		<input type="checkbox"/> AS BUILT			
SCALE		1:100 @ A2		DATE		Mar. 2025
DRAWN		AKS		CHK		AT
DRAWING NO.		19400/253		REV		A
TITLE		Redevelopment of Former Animal Testing Research Facility, Kentford.				
DETAILS		House Type M1- r, M1.1- r, M2- r & M3- f First Floor Plans Plots 220-227				

# Woods Hardwick

Architecture | Engineering | Planning | Surveying

**BEDFORD : HEAD OFFICE**  
15-17 Goldington Road  
Bedford MK40 3NH  
T: +44 (0) 1234 268862

**BIRMINGHAM**  
Fort Dunlop, Fort Parkway  
Birmingham B24 9FE  
T: +44 (0) 121 6297784

ONLINE: [mail@woodshardwick.com](mailto:mail@woodshardwick.com) | [woodshardwick.com](http://woodshardwick.com)

