

Type R-f.  
First Floor Plan.

Type J2-f.  
First Floor Plan.

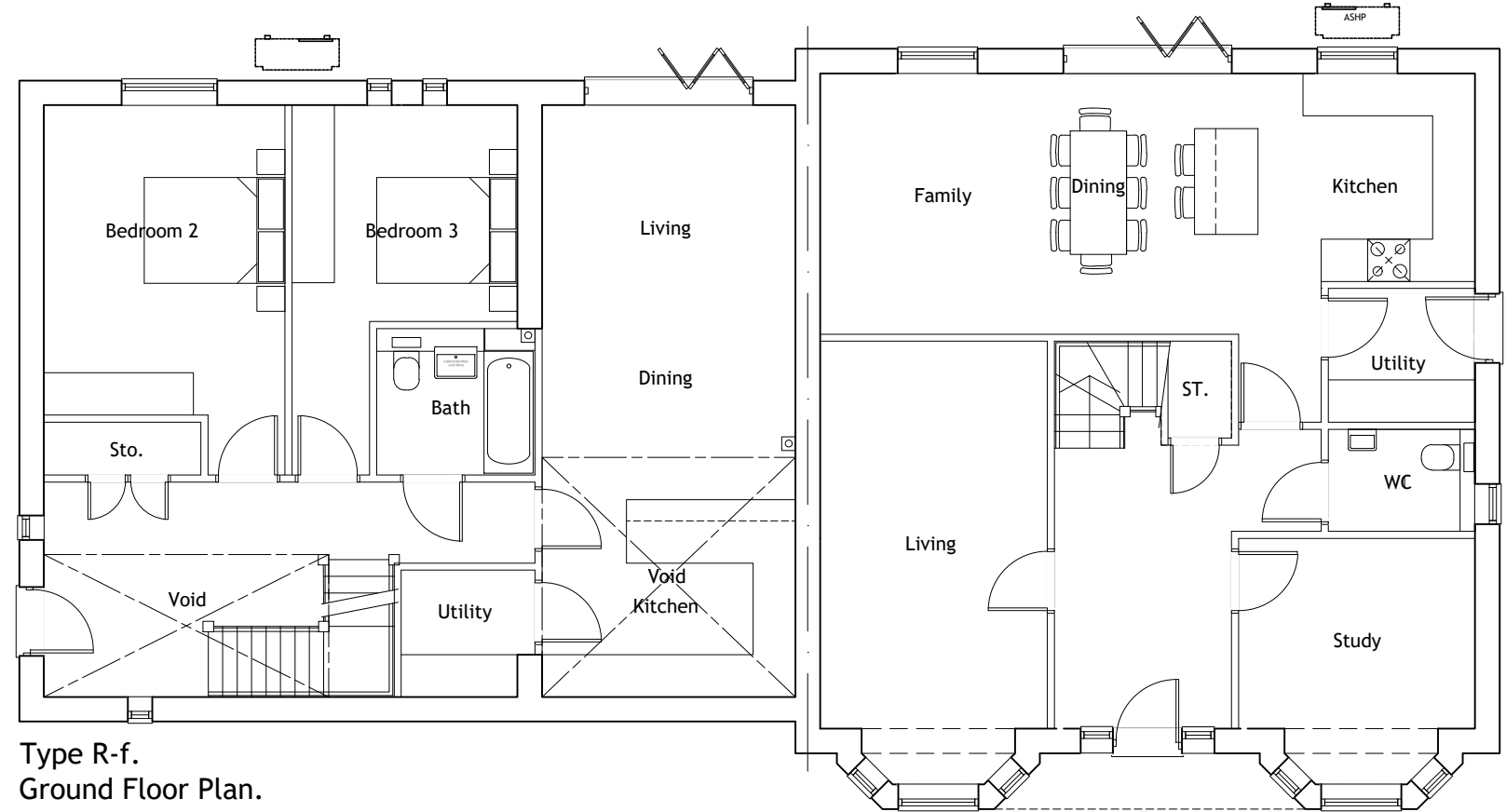

Type R-f.  
Ground Floor Plan.  
132sq.m / 1,420sq.ft.  
4 Bed 7 Person.

Type J2-f.  
Ground Floor Plan.  
176sq.m / 1,893sq.ft.  
5 Bed 9 Person.

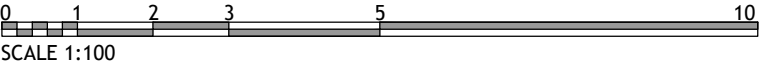

NOTES

- Contractors must check all dimensions on site. Only figured dimensions are to be worked from. Discrepancies must be reported to the Architect or Engineer before proceeding.  
© This drawing is copyright.
- Direct scaling off the drawing is permissible for planning purposes only.



REV	DESCRIPTION	DRN	CHD	DATE	
<input checked="" type="checkbox"/>	PRELIMINARY	<input type="checkbox"/>	INFORMATION	<input type="checkbox"/>	TENDER
<input type="checkbox"/>	CONSTRUCTION	<input type="checkbox"/>	AS BUILT		
SCALE	1:100 @ A3	DATE	May. 2024		
DRAWN	AKS	CHK	JL		
DRAWING NO.	19400/260	REV	-		
TITLE	Redevelopment of Former Animal Testing Research Facility, Kentford.				
DETAILS	House Type J2-F & R-f Floor Plans				



**BEDFORD : HEAD OFFICE**  
15-17 Goldington Road  
Bedford MK40 3NH  
T: +44 (0) 1234 268862  
ONLINE: mail@woodshardwick.com | woodshardwick.com

**BIRMINGHAM**  
Fort Dunlop, Fort Parkway  
Birmingham B24 9FE  
T: +44 (0) 121 6297784