

**Project Number A-01926 (6724)**

**Refurbishment and Demolition  
Asbestos Survey Report**

**Equine Barns  
Lanwades Park  
Newmarket  
CB8 7UA**



Working in Partnership with Shield Services Group



| Document Name | Author         | Issued by | Revision Number | Issue Date | Page No |
|---------------|----------------|-----------|-----------------|------------|---------|
| 2022          | Jamie Houghton | Armour AS | 0               | 09/12/2022 | 1       |

## Contents

| <b>Section</b> |  |
|----------------|--|
| <b>1</b>       | <b>Contacts &amp; Authorisation</b>              |
| <b>2</b>       | <b>Executive Summary</b>                         |
| <b>3</b>       | <b>Site Description &amp; Survey Information</b> |
| <b>4</b>       | <b>Positive and Presumed Photos Sheets</b>       |
| <b>5</b>       | <b>Negative Photos Sheets</b>                    |
| <b>6</b>       | <b>Survey Objectives</b>                         |
| <b>7</b>       | <b>Survey Techniques</b>                         |
| <b>8</b>       | <b>Survey Caveat</b>                             |
| <b>9</b>       | <b>Survey Notes</b>                              |
| <b>10</b>      | <b>Material Assessment Algorithm</b>             |
| <b>11</b>      | <b>Certificates of Bulk Analysis</b>             |
| <b>12</b>      | <b>Site Plan</b>                                 |



## **Section 1: Contact Details**

| <b>Client Details:</b>   |                    | <b>Instructing Party:</b>  |                    |
|--|--------------------|--|--------------------|
| <b>Lochailort Investments Ltd</b><br>(Company Number: 05605197)<br>Eagle House<br>108-110 Jermyn Street<br>London<br>SW1Y 6EE; and<br><br>Such associated company of Locailhort Investments Ltd as is notified in writing to the consultant, and;<br><br><b>Animal Health Trust (in Liquidation)</b><br>(Royal Charter Company Number: RC000011 and Registered Charity Number: 209642) acting by the Receivers; and<br><br><b>Andrew Burton Hughes and Julian Paul Smith</b> of Alder King LLP<br>(Company Number: OC306796) whose registered office is at, Pembroke House, Clifton, Bristol BS8 3BA acting in their capacity as joint receivers of the Premises (the "Receivers") |                    | Lochailort Investments Ltd<br>Eagle House<br>108-110 Jermyn Street<br>London<br>SW1Y 6EE |                    |
| <b>Contact Name:</b>   | Hugo Haig          | <b>Contact Name:</b>   | Hugo Haig          |
| <b>Tel:</b><br>0203 468 4933   | <b>Fax:</b><br>N/A | <b>Tel:</b><br>0203 468 4933   | <b>Fax:</b><br>N/A |

| <b>Site Address:</b>                                  |                    | <b>Report Author:</b>  |               |
|---|--------------------|--|---------------|
| Equine Barns<br>Lanwades Park<br>Newmarket<br>CB8 7UA |                    | Armour Analytical Services<br>Unit 6<br>Guardian Street Industrial Estate<br>Warrington<br>WA5 1SJ |               |
| <b>Contact Name:</b>                                  | Hugo Haig          | <b>Contact Name:</b>   | Andrea Bansee |
| <b>Tel:</b><br>0203 468 4933                          | <b>Fax:</b><br>N/A | <b>Mobile:</b> 07468535836   |               |

| <b>Lead Surveyor's Name:</b> | <b>Lead Surveyor's Authorising Signature:</b> |
|------------------------------|---|
| Jamie Houghton               |   |

| Document Name | Author         | Issued by | Revision Number | Issue Date | Page No |
|---------------|----------------|-----------|-----------------|------------|---------|
| 2022          | Jamie Houghton | Armour AS | 0               | 09/12/2022 | 3       |



## **Section 2: Executive Summary**

| Sample Number | Sample Type                                    | Location                   | Analysis   |
|---------------|--|----------------------------|------------|
| JH/01         | Cement Roof Sheets & Cladding - Cement Product | External Barn 001          | Chrysotile |
| JH/02         | Cement Roof Sheets - Cement Product            | External Small Stables 003 | Chrysotile |
| JH/03         | Sink Pad - Bituminous Product                  | Ground Floor Stable 2 005  | N.A.D.I.S  |
| JH/04         | Cement Roof Sheets - Cement Product            | External Small Stables 008 | Chrysotile |
| JH/05         | Cement Roof Sheet - Cement Product             | External Large Stable 012  | Chrysotile |

N.A.D.I.S – No Asbestos Detected in Sample

A.D – Asbestos Detected

| Document Name | Author         | Issued by | Revision Number | Issue Date | Page No |
|---------------|----------------|-----------|-----------------|------------|---------|
| 2022          | Jamie Houghton | Armour AS | 0               | 09/12/2022 | 4       |

## **Section 3: Site Description & Survey Information**

### **Brief description on the general building construction**

Barn and Stable complex, mostly timber construction. Estimated build circa 1990's.

### **Caveat for no access areas**

All areas accessed ok

### **EXTERNAL MATERIALS**

|                      |                      |
|----------------------|----------------------|
| Roof Type            | Pitched              |
| Roof Materials       | Cement, Timber, Felt |
| Soffits              | None                 |
| Fascia               | None                 |
| Walls                | Timber               |
| Verge Under cloaking | None                 |
| Guttering            | Plastic              |
| Downpipes            | Plastic              |
| Window/Door frames   | None                 |
| Other Materials      | None                 |

### **INTERNAL MATERIALS**

|                            |               |
|----------------------------|---------------|
| Loft Insulation            | None          |
| Roof Underlining           | None          |
| Ceilings                   | Timber        |
| Walls <i>Internal</i>      | Timber, Block |
| Floors                     | Stone         |
| Doors/Frames               | Timber        |
| Pipework/Insulation        | None          |
| Boxings                    | None          |
| Boiler Make                | None          |
| Flue Pipes                 | Plastic       |
| Storage Heaters            | None          |
| Electrical Boxes/Machinery | Modern        |
| Ducting/Risers             | None          |
| Stairs                     | None          |
| Lift Shafts                | None          |
| Other Materials            | None          |

## Section 4: Positive and Presumed Photos Sheets

|                  |                     |                   |              |
|------------------|---------------------|-------------------|--------------|
| <b>Item No:</b>  | <b>1</b>            | <b>Sample No:</b> | <b>JH/01</b> |
| <b>Location:</b> | External - Barn 001 |                   |              |



|                                   |  |                  |
|-----------------------------------|--|------------------|
| <b>Material Description:</b>      | Cement Roof Sheets & Cladding - Cement Product   |                  |
| <b>Identification:</b>            | Sampled - Asbestos Detected  |                  |
| <b>Approx. quantity:</b>          | 120 m <sup>2</sup>   |                  |
| <b>Accessibility</b>              | Medium   | Assessment Score |
| <b>Product type:</b>              | Cement   | 1                |
| <b>Extent of Damage:</b>          | Slight / minor damage  | 1                |
| <b>Surface Treatment:</b>         | Unsealed Cement  | 1                |
| <b>Asbestos type:</b>             | Chrysotile   | 1                |
| <b>Material Assessment Score:</b> |  | 4                |
| <b>Risk Assessment Score:</b>     |  | Negligible       |
| <b>Action:</b>                    | Remove if likely to be disturbed by works  |                  |
| <b>Comments:</b>                  | Sampled cement roof, metal structure, plastic gutters and downpipes, concrete floor<br>Corrugated roof sheets to external barn |                  |

| Document Name | Author         | Issued by | Revision Number | Issue Date | Page No |
|---------------|----------------|-----------|-----------------|------------|---------|
| 2022          | Jamie Houghton | Armour AS | 0               | 09/12/2022 | 6       |

**Item No:** 3

**Sample No:** JH/02

**Location:** External - Small Stables 003



|                                   |  |                  |
|-----------------------------------|--|------------------|
| <b>Material Description:</b>      | Cement Roof Sheets - Cement Product  |                  |
| <b>Identification:</b>            | Sampled - Asbestos Detected  |                  |
| <b>Approx. quantity:</b>          | 39 m <sup>2</sup>  |                  |
| <b>Accessibility</b>              | Medium   | Assessment Score |
| <b>Product type:</b>              | Cement   | 1                |
| <b>Extent of Damage:</b>          | Slight / minor damage  | 1                |
| <b>Surface Treatment:</b>         | Unsealed Cement  | 1                |
| <b>Asbestos type:</b>             | Chrysotile   | 1                |
| <b>Material Assessment Score:</b> |  | 4                |
| <b>Risk Assessment Score:</b>     |  | Negligible       |
| <b>Action:</b>                    | Remove if likely to be disturbed by works  |                  |
| <b>Comments:</b>                  | Samples cement roof, timber construction, plastic gutters and downpipes, plastic windows, concrete floor<br>Cement roof sheets to pitched roof of small stable |                  |

| Document Name | Author         | Issued by | Revision Number | Issue Date | Page No |
|---------------|----------------|-----------|-----------------|------------|---------|
| 2022          | Jamie Houghton | Armour AS | 0               | 09/12/2022 | 7       |



**Item No:** 8

**Sample No:** JH/04

**Location:** External - Small Stables 008



|                                   |  |                  |
|-----------------------------------|--|------------------|
| <b>Material Description:</b>      | Cement Roof Sheets - Cement Product  |                  |
| <b>Identification:</b>            | Sampled - Asbestos Detected  |                  |
| <b>Approx. quantity:</b>          | 39 m <sup>2</sup>  |                  |
| <b>Accessibility</b>              | Medium   | Assessment Score |
| <b>Product type:</b>              | Cement   | 1                |
| <b>Extent of Damage:</b>          | Slight / minor damage  | 1                |
| <b>Surface Treatment:</b>         | Unsealed Cement  | 1                |
| <b>Asbestos type:</b>             | Chrysotile   | 1                |
| <b>Material Assessment Score:</b> |  | 4                |
| <b>Risk Assessment Score:</b>     |  | Negligible       |
| <b>Action:</b>                    | Remove if likely to be disturbed by works  |                  |
| <b>Comments:</b>                  | Samples cement roof, timber construction, plastic gutters and downpipes, plastic windows, concrete floor<br>Cement roof sheets to pitched roof of small stable |                  |

| Document Name | Author         | Issued by | Revision Number | Issue Date | Page No |
|---------------|----------------|-----------|-----------------|------------|---------|
| 2022          | Jamie Houghton | Armour AS | 0               | 09/12/2022 | 8       |



**Item No:** 12

**Sample No:** JH/05

**Location:** External - Large Stable 012



|                                   |  |                  |
|-----------------------------------|--|------------------|
| <b>Material Description:</b>      | Cement Roof Sheet - Cement Product   |                  |
| <b>Identification:</b>            | Sampled - Asbestos Detected  |                  |
| <b>Approx. quantity:</b>          | 90 m <sup>2</sup>  |                  |
| <b>Accessibility</b>              | Difficult  | Assessment Score |
| <b>Product type:</b>              | Cement   | 1                |
| <b>Extent of Damage:</b>          | Slight / minor damage  | 1                |
| <b>Surface Treatment:</b>         | Unsealed Cement  | 1                |
| <b>Asbestos type:</b>             | Chrysotile   | 1                |
| <b>Material Assessment Score:</b> |  | 4                |
| <b>Risk Assessment Score:</b>     |  | Negligible       |
| <b>Action:</b>                    | Remove if likely to be disturbed by works  |                  |
| <b>Comments:</b>                  | Sampled roof, metal frame, timber panels to walls, timber walls, metal and timber door, concrete floor<br>Cement roof sheets to entirety of the stable |                  |

| Document Name | Author         | Issued by | Revision Number | Issue Date | Page No |
|---------------|----------------|-----------|-----------------|------------|---------|
| 2022          | Jamie Houghton | Armour AS | 0               | 09/12/2022 | 9       |

## Section 5: Negative Photos Sheets

|                  |                     |                   |            |
|------------------|---------------------|-------------------|------------|
| <b>Item No:</b>  | <b>2</b>            | <b>Sample No:</b> | <b>N/A</b> |
| <b>Location:</b> | External - Barn 002 |                   |            |



|                                   |   |                         |
|-----------------------------------|---|-------------------------|
| <b>Material Description:</b>      | No Suspect Materials Found  |                         |
| <b>Identification:</b>            | N/A   |                         |
| <b>Approx. quantity:</b>          | N/A   |                         |
| <b>Accessibility</b>              | N/A   | <i>Assessment Score</i> |
| <b>Product type:</b>              | N/A   | N/A                     |
| <b>Extent of Damage:</b>          | N/A   | N/A                     |
| <b>Surface Treatment:</b>         | N/A   | N/A                     |
| <b>Asbestos type:</b>             | N/A   | N/A                     |
| <b>Material Assessment Score:</b> |   | N/A                     |
| <b>Risk Assessment Score:</b>     |   | N/A                     |
| <b>Action:</b>                    | N/A   |                         |
| <b>Comments:</b>                  | Corrugated sheet metal roof, timber structural frame, timber fencing, plastic gutter and downpipes, stone floor |                         |

| Document Name | Author         | Issued by | Revision Number | Issue Date | Page No |
|---------------|----------------|-----------|-----------------|------------|---------|
| 2022          | Jamie Houghton | Armour AS | 0               | 09/12/2022 | 10      |

|                  |                             |                   |            |
|------------------|-----------------------------|-------------------|------------|
| <b>Item No:</b>  | <b>4</b>                    | <b>Sample No:</b> | <b>N/A</b> |
| <b>Location:</b> | Ground Floor - Stable 1 004 |                   |            |



|                                   |   |                         |
|-----------------------------------|---|-------------------------|
| <b>Material Description:</b>      | No Suspect Materials Found  |                         |
| <b>Identification:</b>            | N/A   |                         |
| <b>Approx. quantity:</b>          | N/A   |                         |
| <b>Accessibility</b>              | N/A   | <i>Assessment Score</i> |
| <b>Product type:</b>              | N/A   | N/A                     |
| <b>Extent of Damage:</b>          | N/A   | N/A                     |
| <b>Surface Treatment:</b>         | N/A   | N/A                     |
| <b>Asbestos type:</b>             | N/A   | N/A                     |
| <b>Material Assessment Score:</b> |   | N/A                     |
| <b>Risk Assessment Score:</b>     |   | N/A                     |
| <b>Action:</b>                    | N/A   |                         |
| <b>Comments:</b>                  | sampled ceiling, timber walls, timber wall fascia, concrete floor |                         |

| Document Name | Author         | Issued by | Revision Number | Issue Date | Page No |
|---------------|----------------|-----------|-----------------|------------|---------|
| 2022          | Jamie Houghton | Armour AS | 0               | 09/12/2022 | 11      |

**Item No:** 5

**Sample No:** JH/03

**Location:** Ground Floor - Stable 2 005



|                                   |  |                         |
|-----------------------------------|--|-------------------------|
| <b>Material Description:</b>      | Sink Pad - Bituminous Product  |                         |
| <b>Identification:</b>            | Sampled - No Asbestos Found  |                         |
| <b>Approx. quantity:</b>          | N/A  |                         |
| <b>Accessibility</b>              | N/A  | <i>Assessment Score</i> |
| <b>Product type:</b>              | N/A  | N/A                     |
| <b>Extent of Damage:</b>          | N/A  | N/A                     |
| <b>Surface Treatment:</b>         | N/A  | N/A                     |
| <b>Asbestos type:</b>             | N/A  | N/A                     |
| <b>Material Assessment Score:</b> |  | N/A                     |
| <b>Risk Assessment Score:</b>     |  | N/A                     |
| <b>Action:</b>                    | N/A  |                         |
| <b>Comments:</b>                  | Plasterboard walls and ceiling, timber cabinets, plastic and metal pipework, timber window frame and sill, concrete floor<br>Sink pad located below metal sink within stable |                         |

| Document Name | Author         | Issued by | Revision Number | Issue Date | Page No |
|---------------|----------------|-----------|-----------------|------------|---------|
| 2022          | Jamie Houghton | Armour AS | 0               | 09/12/2022 | 12      |

**Item No:** 6

**Sample No:** N/A

**Location:** Ground Floor - Stable 3 006

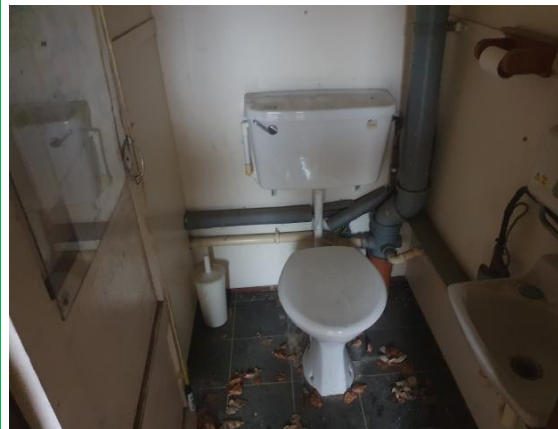

|                                   |   |                         |
|-----------------------------------|---|-------------------------|
| <b>Material Description:</b>      | No Suspect Materials Found  |                         |
| <b>Identification:</b>            | N/A   |                         |
| <b>Approx. quantity:</b>          | N/A   |                         |
| <b>Accessibility</b>              | N/A   | <i>Assessment Score</i> |
| <b>Product type:</b>              | N/A   | N/A                     |
| <b>Extent of Damage:</b>          | N/A   | N/A                     |
| <b>Surface Treatment:</b>         | N/A   | N/A                     |
| <b>Asbestos type:</b>             | N/A   | N/A                     |
| <b>Material Assessment Score:</b> |   | N/A                     |
| <b>Risk Assessment Score:</b>     |   | N/A                     |
| <b>Action:</b>                    | N/A   |                         |
| <b>Comments:</b>                  | Sampled ceiling, timber partitions and walls, timber doors and frames, modern facilities, plastic and metal pipework, tiled and concrete floor. |                         |

| Document Name | Author         | Issued by | Revision Number | Issue Date | Page No |
|---------------|----------------|-----------|-----------------|------------|---------|
| 2022          | Jamie Houghton | Armour AS | 0               | 09/12/2022 | 13      |



**Item No:** 7

**Sample No:** N/A

**Location:** Ground Floor - Stable 4 007



|                                   |   |                         |
|-----------------------------------|---|-------------------------|
| <b>Material Description:</b>      | No Suspect Materials Found  |                         |
| <b>Identification:</b>            | N/A   |                         |
| <b>Approx. quantity:</b>          | N/A   |                         |
| <b>Accessibility</b>              | N/A   | <i>Assessment Score</i> |
| <b>Product type:</b>              | N/A   | N/A                     |
| <b>Extent of Damage:</b>          | N/A   | N/A                     |
| <b>Surface Treatment:</b>         | N/A   | N/A                     |
| <b>Asbestos type:</b>             | N/A   | N/A                     |
| <b>Material Assessment Score:</b> |   | N/A                     |
| <b>Risk Assessment Score:</b>     |   | N/A                     |
| <b>Action:</b>                    | N/A   |                         |
| <b>Comments:</b>                  | Plasterboard ceiling and walls, timber window frame, modern electrical units, timber door and frame, timber window frame and sill, laminate floor to concrete |                         |

| Document Name | Author         | Issued by | Revision Number | Issue Date | Page No |
|---------------|----------------|-----------|-----------------|------------|---------|
| 2022          | Jamie Houghton | Armour AS | 0               | 09/12/2022 | 14      |

**Item No:** 9

**Sample No:** N/A

**Location:** Ground Floor - Stable 5 009



|                                   |  |                         |
|-----------------------------------|--|-------------------------|
| <b>Material Description:</b>      | No Suspect Materials Found   |                         |
| <b>Identification:</b>            | N/A  |                         |
| <b>Approx. quantity:</b>          | N/A  |                         |
| <b>Accessibility</b>              | N/A  | <i>Assessment Score</i> |
| <b>Product type:</b>              | N/A  | N/A                     |
| <b>Extent of Damage:</b>          | N/A  | N/A                     |
| <b>Surface Treatment:</b>         | N/A  | N/A                     |
| <b>Asbestos type:</b>             | N/A  | N/A                     |
| <b>Material Assessment Score:</b> |  | N/A                     |
| <b>Risk Assessment Score:</b>     |  | N/A                     |
| <b>Action:</b>                    | N/A  |                         |
| <b>Comments:</b>                  | Timber ceiling and walls, timber window frame, timber door and frame, timber window frame and sill, lino floor to concrete |                         |



**Item No:** 10

**Sample No:** N/A

**Location:** Ground Floor - Stable 6, 7 & 8 010



|                                   |   |                         |
|-----------------------------------|---|-------------------------|
| <b>Material Description:</b>      | No Suspect Materials Found  |                         |
| <b>Identification:</b>            | N/A   |                         |
| <b>Approx. quantity:</b>          | N/A   |                         |
| <b>Accessibility</b>              | N/A   | <i>Assessment Score</i> |
| <b>Product type:</b>              | N/A   | N/A                     |
| <b>Extent of Damage:</b>          | N/A   | N/A                     |
| <b>Surface Treatment:</b>         | N/A   | N/A                     |
| <b>Asbestos type:</b>             | N/A   | N/A                     |
| <b>Material Assessment Score:</b> |   | N/A                     |
| <b>Risk Assessment Score:</b>     |   | N/A                     |
| <b>Action:</b>                    | N/A   |                         |
| <b>Comments:</b>                  | sampled ceiling, timber walls, timber wall fascia, concrete floor |                         |

**Item No:** 11

**Sample No:** N/A

**Location:** External - Shed 011



|                                   |  |                         |
|-----------------------------------|--|-------------------------|
| <b>Material Description:</b>      | No Suspect Materials Found   |                         |
| <b>Identification:</b>            | N/A  |                         |
| <b>Approx. quantity:</b>          | N/A  |                         |
| <b>Accessibility</b>              | N/A  | <i>Assessment Score</i> |
| <b>Product type:</b>              | N/A  | N/A                     |
| <b>Extent of Damage:</b>          | N/A  | N/A                     |
| <b>Surface Treatment:</b>         | N/A  | N/A                     |
| <b>Asbestos type:</b>             | N/A  | N/A                     |
| <b>Material Assessment Score:</b> |  | N/A                     |
| <b>Risk Assessment Score:</b>     |  | N/A                     |
| <b>Action:</b>                    | N/A  |                         |
| <b>Comments:</b>                  | Timber construction shed store, pitched felt roof, plastic gutters and downpipes, concrete floor |                         |

**Item No:** 13

**Sample No:** N/A

**Location:** External - Gas Tank Store 013



|                                   |  |                         |
|-----------------------------------|--|-------------------------|
| <b>Material Description:</b>      | No Suspect Materials Found                             |                         |
| <b>Identification:</b>            | N/A  |                         |
| <b>Approx. quantity:</b>          | N/A  |                         |
| <b>Accessibility</b>              | N/A  | <i>Assessment Score</i> |
| <b>Product type:</b>              | N/A  | N/A                     |
| <b>Extent of Damage:</b>          | N/A  | N/A                     |
| <b>Surface Treatment:</b>         | N/A  | N/A                     |
| <b>Asbestos type:</b>             | N/A  | N/A                     |
| <b>Material Assessment Score:</b> |  | N/A                     |
| <b>Risk Assessment Score:</b>     |  | N/A                     |
| <b>Action:</b>                    | N/A  |                         |
| <b>Comments:</b>                  | Metal tank, brick and block construction, plastic hose |                         |

**Item No:** 14

**Sample No:** N/A

**Location:** External - Store 014



|                                   |  |                         |
|-----------------------------------|--|-------------------------|
| <b>Material Description:</b>      | No Suspect Materials Found                   |                         |
| <b>Identification:</b>            | N/A  |                         |
| <b>Approx. quantity:</b>          | N/A  |                         |
| <b>Accessibility</b>              | N/A  | <i>Assessment Score</i> |
| <b>Product type:</b>              | N/A  | N/A                     |
| <b>Extent of Damage:</b>          | N/A  | N/A                     |
| <b>Surface Treatment:</b>         | N/A  | N/A                     |
| <b>Asbestos type:</b>             | N/A  | N/A                     |
| <b>Material Assessment Score:</b> |  | N/A                     |
| <b>Risk Assessment Score:</b>     |  | N/A                     |
| <b>Action:</b>                    | N/A  |                         |
| <b>Comments:</b>                  | Metal roof sheets, timber construction store |                         |





## **Section 6: Survey Objectives**

Instructions were received from Hugo Haig of Lochailort Investments Ltd to carry out a Refurbishment and Demolition asbestos survey at Equine Barns, Lanwades Park, Newmarket, CB8 7UA in accordance with HSG264 and Armour Analytical's quality procedures.

The survey was carried out on 22 November 2022 by Jamie Houghton with the objective of facilitating Refurbishment or Demolition works.

This Refurbishment & Demolition survey is characterised as a 'Full Access Sampling and Identification Survey' in HSG264. This type of survey is used to locate and describe, so far as are reasonably practicable, all asbestos containing materials (ACMs) in the building and will by its nature involve the partial destruction of the building's fabric as access is gained to all areas. A full sampling programme is undertaken to identify possible ACMs and estimate the extent of ACMs reported. A Refurbishment survey should be undertaken in an unoccupied building.

The objective of this survey report is to identify, so far as is reasonably practicable, the location, extent, product type and composition of ACMS within the fabric of the building, prior to said buildings major refurbishment or demolition.

| Document Name | Author         | Issued by | Revision Number | Issue Date | Page No |
|---------------|----------------|-----------|-----------------|------------|---------|
| 2022          | Jamie Houghton | Armour AS | 0               | 09/12/2022 | 20      |



## **Section 7: Survey Techniques**

Each floor, room and area within the scope was systematically inspected for suspect materials thought or known to contain asbestos and where such materials were encountered their location, extent, and composition were recorded.

Where materials of a similar nature exist, to those previously sampled, and a reasoned argument can be made that their composition is likely to be identical further physical sampling was not undertaken.

Photographs were taken of all sample locations, unless otherwise stated.

The analysis of suspect ACMs was undertaken by a UKAS accredited laboratory using the analytical method detailed in *HSG248, Appendix 2 -Asbestos: The analysts' guide for sampling, analysis and clearance procedures*.

| Document Name | Author         | Issued by | Revision Number | Issue Date | Page No |
|---------------|----------------|-----------|-----------------|------------|---------|
| 2022          | Jamie Houghton | Armour AS | 0               | 09/12/2022 | 21      |



## **Section 8: Survey Caveat**

This report is based upon a destructive inspection of an unfamiliar site. During the course of the survey all reasonable efforts were made to identify the physical presence of materials containing asbestos within the areas of the building which are subject to future refurbishment or demolition works.

This report will be restricted to the areas that fall within the scope of works for project and will not take into account any area's that do not fall within the scope. Any asbestos that is identified within this report will need to be added to the buildings existing information and should not form the basis for a management survey. This survey will not include priority assessments nor will it include a register.

This survey considered the construction of the building, associated fixtures & fittings and associated structures and in no way should it be considered as a ground investigation report.

Services should be disconnected prior to commencement of a Refurbishment survey; however where plant and/or electrical installations are live or appear to be live then these will not be accessed.

Inspection under floor slab is not included unless core hole sampling has been specifically requested.

This survey report is not a bill of quantities.

| Document Name | Author         | Issued by | Revision Number | Issue Date | Page No |
|---------------|----------------|-----------|-----------------|------------|---------|
| 2022          | Jamie Houghton | Armour AS | 0               | 09/12/2022 | 22      |





## **Section 9: Survey Notes**

This report has been written with reference to the various Guidance Notes etc, issued, and current at the date of this report and describes circumstances at the site on the date the investigation took place.

Where similar items exist in the building, only one or two samples have been taken to ascertain the material content. It was assumed that similar products were of the same material.

Any person undertaking work within the buildings should be told of the presence of asbestos. This briefing also applies to any other person associated with the site, including staff, sub-contractors and others.

The drawings in the report are not to scale and are illustrative only to indicate approximate locations. The descriptions used are for location identification purposes.

All the recommendations described in this report are based upon assumptions made after consideration of the type of material, condition of the material, its location, analysis result and type of use the area is thought to be subjected to. However, statutory authorities or others could require amendments based on local knowledge, change in legislation, change in use or indeed other conditions or criteria.

Samples taken from floor tiles (or similar material) may include a bitumen adhesive as part of the sample. It is known that some proprietary brands of bitumen have an asbestos content and this will be included as an integral part of the bulk sample unless otherwise stated.

**Due to the artex being non-homogenous, it is recommended to treat all areas as containing asbestos if you have a positive sample of artex.**

| Document Name | Author         | Issued by | Revision Number | Issue Date | Page No |
|---------------|----------------|-----------|-----------------|------------|---------|
| 2022          | Jamie Houghton | Armour AS | 0               | 09/12/2022 | 23      |

## **Section 10: Material Assessment Algorithm**

| Variable           | Score | Examples  |
|--------------------|-------|---|
| Product type       | 1     | Vinyl, 'Bakelite', Cement, Textured Coating, Non-Friable Debris, Floor Tiles, Bitumen, Reinforced Plastics, Mastic (putty), Windowsills |
|                    | 2     | Asbestos Insulating Board, Paper, Rope, Burned Cement Debris, Flashguards, Gaskets  |
|                    | 3     | Pipe Insulation, Spray Coating, Friable Debris, Loose Fill Asbestos   |
| Condition / Damage | 0     | Good  |
|                    | 1     | Slight / Minor Damage   |
|                    | 2     | Moderate Damage – Breakage to Surface Treatment   |
|                    | 3     | Major Damage – Smashed or Exposed Material  |
| Surface Treatment  | 0     | Non-Friable E.G. Vinyl  |
|                    | 1     | Enclosed Insulation, Encapsulated AIB, Unsealed Cement, Woven Material, Paper   |
|                    | 2     | Unsealed AIB, Encapsulated Insulation, Encapsulated Pipe Lagging  |
|                    | 3     | Unsealed Insulation, Spray Coating, Unsealed Pipe Lagging   |
| Asbestos Type      | 1     | Chrysotile  |
|                    | 2     | Amosite & Other Amphiboles  |
|                    | 3     | Crocidolite   |

The scores from each of the four sections are added together to produce a risk score:

| Risk score           | Risk assessment |
|----------------------|-----------------|
| <b>10 or more</b>    | High risk       |
| <b>7 – 9</b>         | Medium risk     |
| <b>5 – 6</b>         | Low risk        |
| <b>4 &amp; below</b> | Negligible risk |

## Section 11: Certificates of Bulk Analysis



Our Ref: J250173 Fl: 5  
Your Ref: 6724/ A - 01926  
Date: 05/12/2022

**ENVIROCHEM**  
Analytical Laboratories Ltd.  
12 The Gardens  
Broadcut, Fareham  
Hampshire  
PO16 8SS



1227  
Tel: (01329) 287777  
Fax: (01329) 287755  
www.envirochem.co.uk  
office@envirochem.co.uk

### Asbestos Fibre Identification Report

Client: Armour Analytical Services Ltd  
Admirals Yard, Station Road, Patchway, Bristol, BS34 6LR  
Site Address: Equine Barns, Landwades Park, Newmarket, CB8 7UA  
Sampled By: Armour Analytical Services Ltd  
Date sampled/received: 2nd December 2022  
Date analysed: 5th December 2022  
Analyst/s: Matt Hurst  
Analysis Location: 12 The Gardens, Broadcut, Fareham, Hampshire, PO16 8SS

#### ANALYTICAL PROCEDURE

Fibre identification was carried out in accordance with the documented 'in-house' method (2.01) based on the HSE Guidance Note HSG 248. These employed stereo microscopy, polarized microscopy and dispersion staining techniques.

#### RESULTS

| Sample No. | Sample Ref. | Location                                    | Asbestos Detected | Asbestos Type |
|------------|-------------|---|-------------------|---------------|
| JH/01      | BS821626    | External. Barn/ Roof. Cement roof sheet.    | Yes               | Chrysotile    |
| JH/02      | BS821627    | External. Small Stables. Cement roof sheet. | Yes               | Chrysotile    |
| JH/03      | BS821628    | Ground floor. Stable 2. Sink pad.           | No                |               |
| JH/04      | BS821629    | External. Small Stables. Cement roof sheet. | Yes               | Chrysotile    |

#### NOTES:

1. Sample(s) were examined for the presence of 6 types of asbestos fibres: crocidolite (blue), amosite (brown), chrysotile (white), anthophyllite, actinolite and tremolite.
2. The results shown in this test report specifically refer to the sample(s) tested as received unless otherwise stated and samples collected by the client are evaluated using information provided by the client. For samples collected by the client the date of receipt is deemed to be the same as the date sampled.
3. Envirochem is a UKAS accredited laboratory for sampling and identification of asbestos containing materials.
4. Comments, observations and opinions are outside the scope of UKAS accreditation.
5. The analytical method in the HSG248 does not quantify the amount of asbestos present, therefore UKAS accreditation does not permit quantification.
6. If, during fibre identification, only 1 or 2 fibres are seen and identified as asbestos, then the term 'trace asbestos identified' is used.
7. This report shall not be reproduced except in full, without written approval of Envirochem.
8. Samples are retained for 6 months, report kept for 5 years from the date of authorisation of this report.

SIGNATURE:



Authorised signatory PRINT NAME: Chloe Bowman

DATE AUTHORISED:  
05/12/2022

Reg. No. 2378228 England. Registered Office: Envirochem, 12 The Gardens, Broadcut, Fareham, Hampshire, PO16 8SS.

Page 1 of 2

| Document Name | Author         | Issued by | Revision Number | Issue Date | Page No |
|---------------|----------------|-----------|-----------------|------------|---------|
| 2022          | Jamie Houghton | Armour AS | 0               | 09/12/2022 | 25      |



Our Ref: J250173 FI: 5  
Your Ref: 6724/ A - 01926  
Date: 05/12/2022

**ENVIROCHEM**  
Analytical Laboratories Ltd.  
12 The Gardens  
Broadcut, Fareham  
Hampshire  
PO16 8SS



1227  
Tel: (01329) 287777  
Fax: (01329) 287755  
www.envirochem.co.uk  
office@envirochem.co.uk

## Asbestos Fibre Identification Report

Client: Armour Analytical Services Ltd  
Admirals Yard, Station Road, Patchway, Bristol, BS34 6LR  
Site Address: Equine Barns, Landwades Park, Newmarket, CB8 7UA  
Sampled By: Armour Analytical Services Ltd  
Date sampled/received: 2nd December 2022  
Date analysed: 5th December 2022  
Analyst/s: Matt Hurst  
Analysis Location: 12 The Gardens, Broadcut, Fareham, Hampshire, PO16 8SS

### ANALYTICAL PROCEDURE

Fibre identification was carried out in accordance with the documented 'in-house' method (2.01) based on the HSE Guidance Note HSG 248. These employed stereo microscopy, polarized microscopy and dispersion staining techniques.

### RESULTS

| Sample No. | Sample Ref. | Location                                   | Asbestos Detected | Asbestos Type |
|------------|-------------|--|-------------------|---------------|
| JH/05      | BS821630    | External. Large Stable. Cement roof sheet. | Yes               | Chrysotile    |

#### NOTES:

1. Sample(s) were examined for the presence of 6 types of asbestos fibres: crocidolite (blue), amosite (brown), chrysotile (white), anthophyllite, actinolite and tremolite.
2. The results shown in this test report specifically refer to the sample(s) tested as received unless otherwise stated and samples collected by the client are evaluated using information provided by the client. For samples collected by the client the date of receipt is deemed to be the same as the date sampled.
3. Envirochem is a UKAS accredited laboratory for sampling and identification of asbestos containing materials.
4. Comments, observations and opinions are outside the scope of UKAS accreditation.
5. The analytical method in the HSG248 does not quantify the amount of asbestos present, therefore UKAS accreditation does not permit quantification.
6. If, during fibre identification, only 1 or 2 fibres are seen and identified as asbestos, then the term 'trace asbestos identified' is used.
7. This report shall not be reproduced except in full, without written approval of Envirochem.
8. Samples are retained for 6 months, report kept for 5 years from the date of authorisation of this report.

SIGNATURE:



Authorised signatory PRINT NAME: Chloe Bowman

DATE AUTHORISED:  
05/12/2022





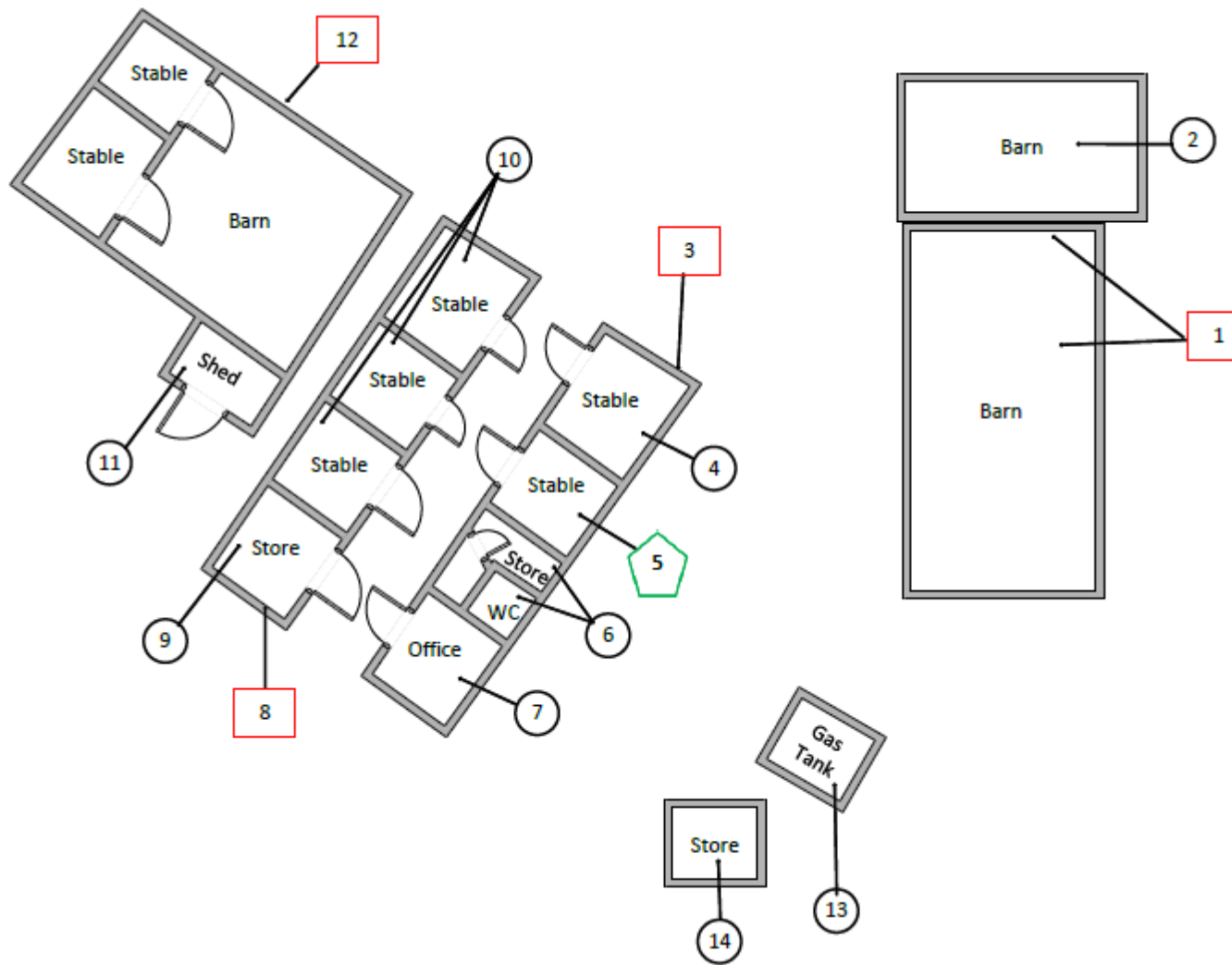

Reg. No. 2378228 England. Registered Office: Envirochem, 12 The Gardens, Broadcut, Fareham, Hampshire, PO16 8SS.

Page 2 of 2

| Document Name | Author         | Issued by | Revision Number | Issue Date | Page No |
|---------------|----------------|-----------|-----------------|------------|---------|
| 2022          | Jamie Houghton | Armour AS | 0               | 09/12/2022 | 26      |

## Section 12: Site Plan



| Key  |                                       |
|--|---------------------------------------|
|  | Visual Inspection                     |
|  | Asbestos Detected (Positive Item)     |
|  | No Asbestos Detected (Negative Item)  |
|  | Presumed to Contain Asbestos          |
|  | Strongly Presumed to Contain Asbestos |
|  | No Access                             |

| Document Name | Author         | Issued by | Revision Number | Issue Date | Page No |
|---------------|----------------|-----------|-----------------|------------|---------|
| 2022          | Jamie Houghton | Armour AS | 0               | 09/12/2022 | 27      |



**I the surveyor can confirm that this report is accurate to my findings onsite and this survey has been Content checked by myself.**

**Checked by: Will Fyles**

**Date: 09/12/2022**

**I the Admin Manager can confirm that this report is accurate to the paperwork received and this survey has been quality checked by myself.**

**Checked by: Andrea Bansee**

**Date: 09/12/2022**

**The Consultant will, on written request, grant to the addressees all licenses required to enable them to use and reproduce any material and documents comprised in the investigation results for any lawful purpose, royalty free.**

**Report Compiled By**

**Armour Analytical Services Ltd, Unit 6, Guardian Street Industrial Estate,  
Warrington, WA5 1SJ**

| Document Name | Author         | Issued by | Revision Number | Issue Date | Page No |
|---------------|----------------|-----------|-----------------|------------|---------|
| 2022          | Jamie Houghton | Armour AS | 0               | 09/12/2022 | 28      |